

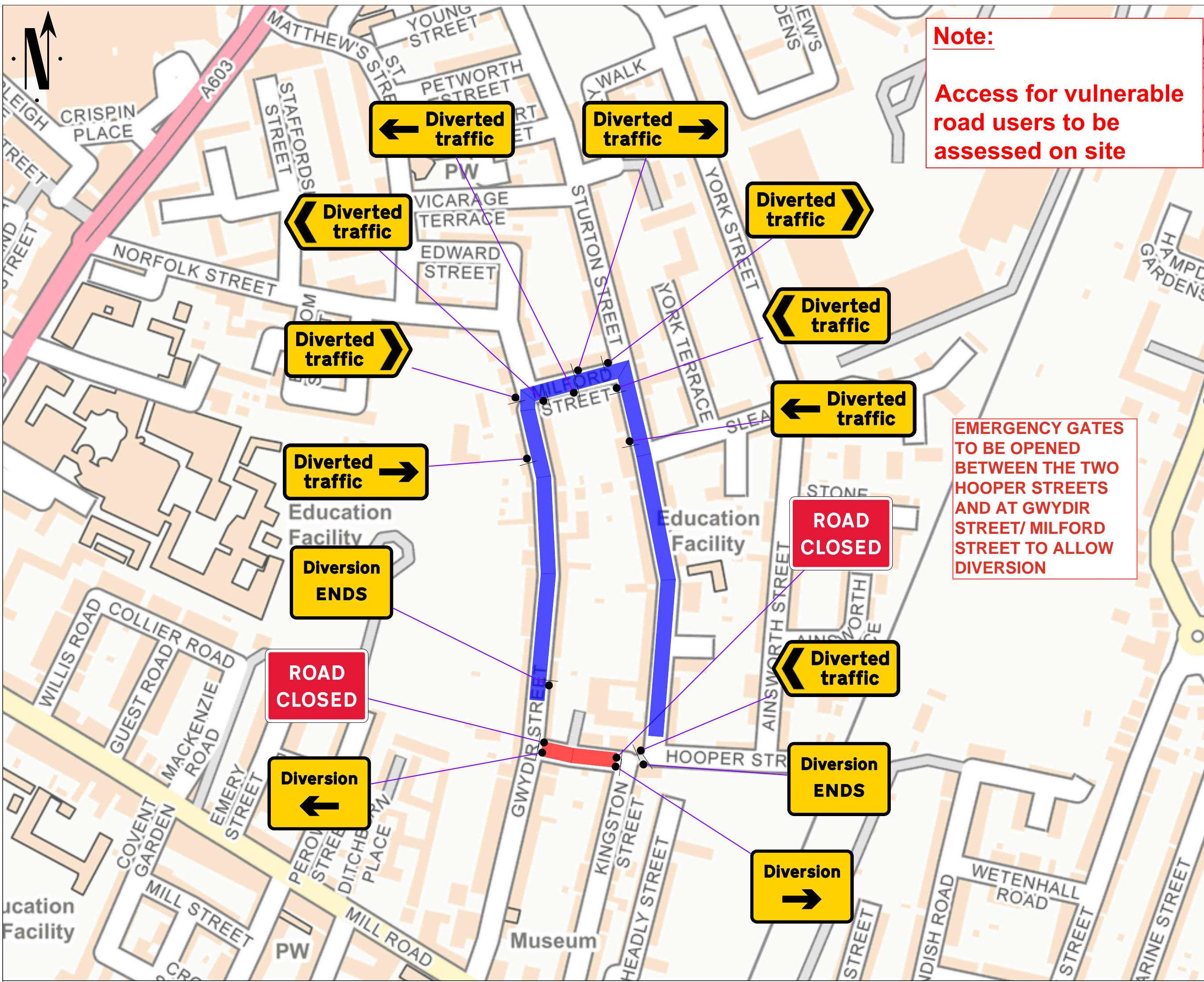

Note:
Access for vulnerable road users to be assessed on site



Go Traffic Management
 This drawing has been produced for a specific client & project identified below and is not intended for use by any other person or for any other purpose. © Go Traffic Management

Risks

1. Design completed from information provided + google maps desktop risk assessment
2. Cone lamps must be used on all road with a speed limit of 40mph or more.

Notes

1. All signs as per Chapter 8. Distances between cones to be 9m maximum unless otherwise noted.
2. Distances between signs NOT to scale for purpose of clarity.
3. All sign placement subject to available safe working space.
4. The purpose of the Traffic Management Plan is for it to be used only as a guide and all traffic management equipment should be put out according to the 'Safety at Street Works and Road Works - Code of Practice', i.e. Red Book & the 'Traffic Signs Manual Chapter 8', i.e. Yellow Book.
5. Signs must be placed in accordance with TSM and the scheme RAMS pack.
6. Site conditions may have changed since the design of the drawing any changes which subsequently affect the design need to be reported by the Traffic Management Operative & any changes implemented must comply with Chapter 8.

Key

- Sign position and aspect of vision
- Road Closure
- Diversion Route

MINIMUM SAFETY ZONE MUST BE ADHERED TO
MINIMUM SHUTTLE LANE WIDTHS MUST BE ADHERED TO
 Traffic Management must comply with The Safety at Street Works and Road Works Code of Practice

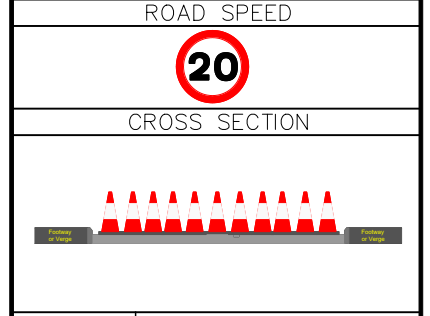

DO NOT SCALE FROM THIS DRAWING.

REV.	DATE	DESCRIPTION
B	30.09.24	Route amended - HB.

GTM
Go Traffic Management

Head Office: Go Traffic Management,
 Chaddock Lane, Worsley, Manchester, M28 1XW
 Tel: 0161 351 5370
 www.gtm.co.uk

CERTIFIED
 ISO 9001:2015
 ISO 14001:2015
 OHSAS 18001

TRAFFIC MANAGEMENT PLAN

Client:

Drawing Number: 836009 - 005

Cambridge Scheme,
 CB2 1LQ

Design:	Technical Officer:	REV:
H.Barnsey	C.Mackinnon	B
Date:	05.12.23	05.12.23